

METAL FRAME

NOTES:

Illustration shows the BioLime plaster system for metal frame-wall construction.

1. BioLime One-Coat 3/8"
2. BioLime Finish 1/8"

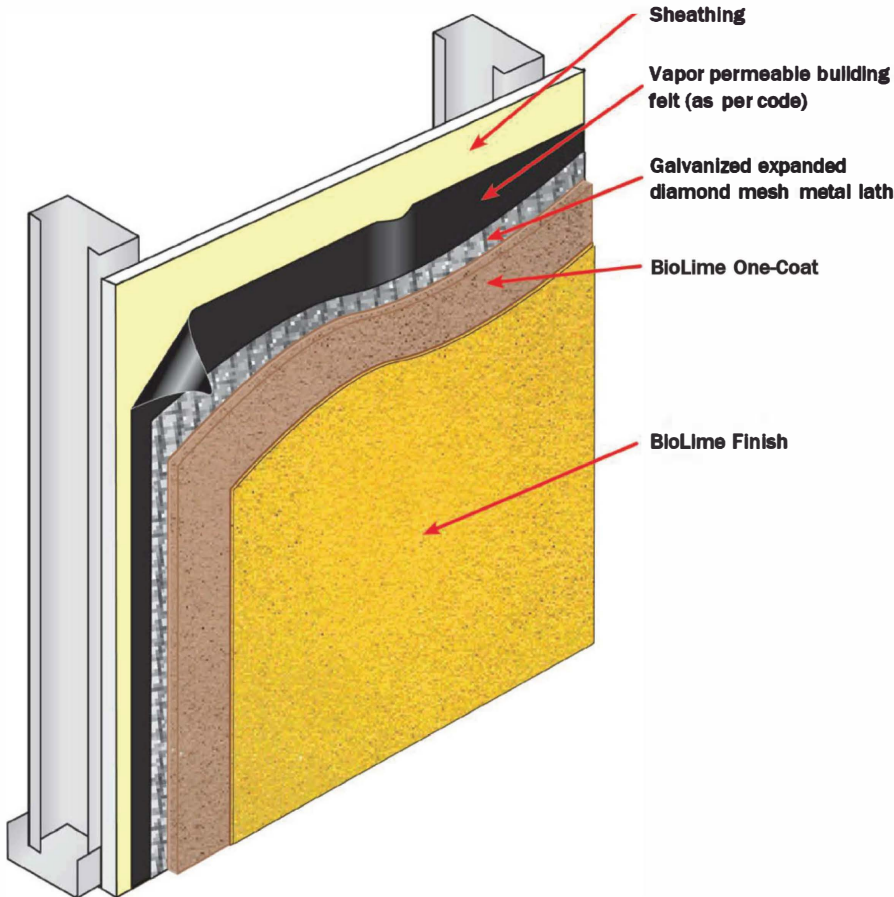

FOR FURTHER DETAIL REFER TO MASTERFORMAT 3-PART SPECIFICATION.



Property of BioLime Inc. © All Rights Reserved.

ADDITIONAL NOTES:

Please consult with the manufacturers and/or suppliers of any separate materials for their product specifications and applications instructions. If site or design conditions not shown in these details are present, or any unusual design is involved other than herein listed, please contact BioLime for further consultation.

NOTES:

These design details are for general information and guidance only for the purpose of illustrating BioLime products for the particular system outlined and is subject to change without notice. To insure that you have the most recent version, please contact BioLime.

IMPORTANT - BioLime products must be installed by qualified professional contractors as a finishing component of a larger construction assembly as specified by a qualified design professional, general contractor or builder. To ensure that the most up to date information of proper application procedures, including other pertinent information, please contact BioLime or visit www.biolime.com.

DISCLAIMER

BIOlime SHALL NOT BE RESPONSIBLE FOR CONSEQUENTIAL, INDIRECT OR INCIDENTAL DAMAGES, LOSS OF PROFITS OF ANY KIND including any assumption and/or any liability for its products improperly applied by unqualified persons or entities. BioLime disclaims all, and assumes no liability for being part of any improperly designed or constructed building, nor guaranty or warranty the non performance of adjacent and/or 3rd party building systems, assemblies, components, products, etc. listed in these illustrations or construction activities beyond them. BioLime shall be liable only as expressly stated in the BioLime Standard Warranty, which may be subject to change from time to time depending on technological progress or further developments. Contact BioLime for a current copy of its warranty.

Vers.12.18

www.biolime.com